

### Full Planting Schedule

Herbaceous	Name	Age	Height	Form	Girth	Cl5m	Blks	Buds	Root	Cr5	Cr5	Qty
Miscanthus sinensis 'Gracillimus'									C	5-7.5L	0.877	28
												28
Shrub	Name	Age	Height	Form	Girth	Cl5m	Blks	Buds	Root	Cr5	Cr5	Qty
Aucuba japonica 'Variegata'			60-80cm				7		C	10L	0.816	5
Berberis thunbergii 'Xanthopurpurea Nana'			30-40cm				4		C	5L	0.877	28
Chionodoxa			40-60cm				7		C	10L	0.816	7
Chionodoxa 'Sunderland'			40-60cm				7		C	10L	0.816	11
Cornus alba 'Elegantissima'			60-80cm				3		C	10-15L		7
Cornus amomum			60-80cm				3		C	5L		5
Cornus pauciflora 'Rosa'			40-60cm						C	10L	0.816	7
Hebe 'Midsummer Beauty'			40-60cm				11		C	10L	0.816	17
Hebe pinguifolia 'Pigea'			30-40cm(D)				5		C	5L	0.877	48
Hypericum perforatum 'Victoria'			40-60cm				6		C	10L	0.816	8
Hypericum perforatum 'Victoria'			40-60cm				7		C	10L	0.816	17
Lavandula angustifolia 'Victoria'			30-40cm				7		C	5L	0.877	24
Lonicera xedera 'Baginawa's Gold'			40-60cm						C	5-7.5L	0.200	564
Prunus laurocerasus 'Olea Laetevirens'			40-60cm				4		C	5L	0.877	48
Prunus laurocerasus			60-80cm				4		C	5-7.5L	0.400	499
Rosmarinus officinalis 'Miss Jessop's Upright'			40-60cm				7		C	10L	0.816	28
Sambucus racemosa 'Plumbea Aurea'			60-80cm				13		C	10-15L		7
Viburnum tinus 'Eve Poinc'			30-40cm				4		C	5L	0.200	166
Viburnum tinus 'Eve Poinc'			30-40cm				4		C	5L	0.877	11
Viburnum tinus 'Eve Poinc'			30-40cm				4		C	5L	0.877	11
Tree	Name	Age	Height	Form	Girth	Cl5m	Blks	Buds	Root	Cr5	Cr5	Qty
Acer campestre		4e	175-200cm	Bushy					B			3
Betula jacquemontii		3e	300-425cm	Standard (Heavy)	12-14cm	175-200cm	70		RB			1
Betula pendula 'Dalecarlia'		3e	300-425cm	Standard (Heavy)	12-14cm	175-200cm	70		RB			1
Betula pubescens		2e	175-200cm	Feathered			6		B			3
Carpinus betulus 'Columnaris'		3e	300-425cm	Standard (Heavy)	12-14cm	min 200cm	52		B			3
Liquidambar styraciflua		3e	300-425cm	Feathered	12-14cm		55		RB			1
Maka 'Red Sentinel'		3e	300-425cm	Standard (Heavy)	12-14cm	175-200cm	54		RB			2
Prunus avium 'Plena'		3e	300-425cm	Standard (Heavy)	12-14cm	175-200cm	48		B			3
Prunus spinosa		3e	300-425cm	Standard (Heavy)	12-14cm	min 200cm	5		B			1
Prunus subhirtella 'Autumnalis'		3e	300-425cm	Standard (Heavy)	12-14cm	175-200cm	58		RB			1
Sorbus aucuparia		2e	175-200cm	Feathered			3		B			1
												20
												1540

**Specification for Soft and Hard Landscaping Works.**

All landscape works shall comply with BS 4428:1989.

**A. Setting Out**

- Planting shall be set out exactly as shown on the drawing and measured from existing fixed points. Control levels shall be set out using total stations or a total station or level. All levels shall be set out to the ground surface. The location between control and planting areas shall be set out to a minimum of 10m. All levels shall be set out to the ground surface. The location between control and planting areas shall be set out to a minimum of 10m. All levels shall be set out to the ground surface. The location between control and planting areas shall be set out to a minimum of 10m.

**B. Ground Preparation**

- The planting area shall be prepared by suitable leveling operations using an approved mechanical control system to manufacturer's instructions and to 1997 Control of Pollution Regulations and 2003 COSHH regulations or all wells, except those which are not used for water supply. The ground shall be prepared to a minimum of 100mm below the finished ground level. The ground shall be prepared to a minimum of 100mm below the finished ground level. The ground shall be prepared to a minimum of 100mm below the finished ground level.

- General Notes for the Developer.**
- Planting shall be carried out in accordance with the specification and schedule of quantities accompanying these drawings. Refer to the specification for the preparation of existing topsoil and required depths for planting, surfacing, and drainage, and also for maintenance requirements.
  - Planting shall be carried out in accordance with the specification and schedule of quantities accompanying these drawings. Refer to the specification for the preparation of existing topsoil and required depths for planting, surfacing, and drainage, and also for maintenance requirements.

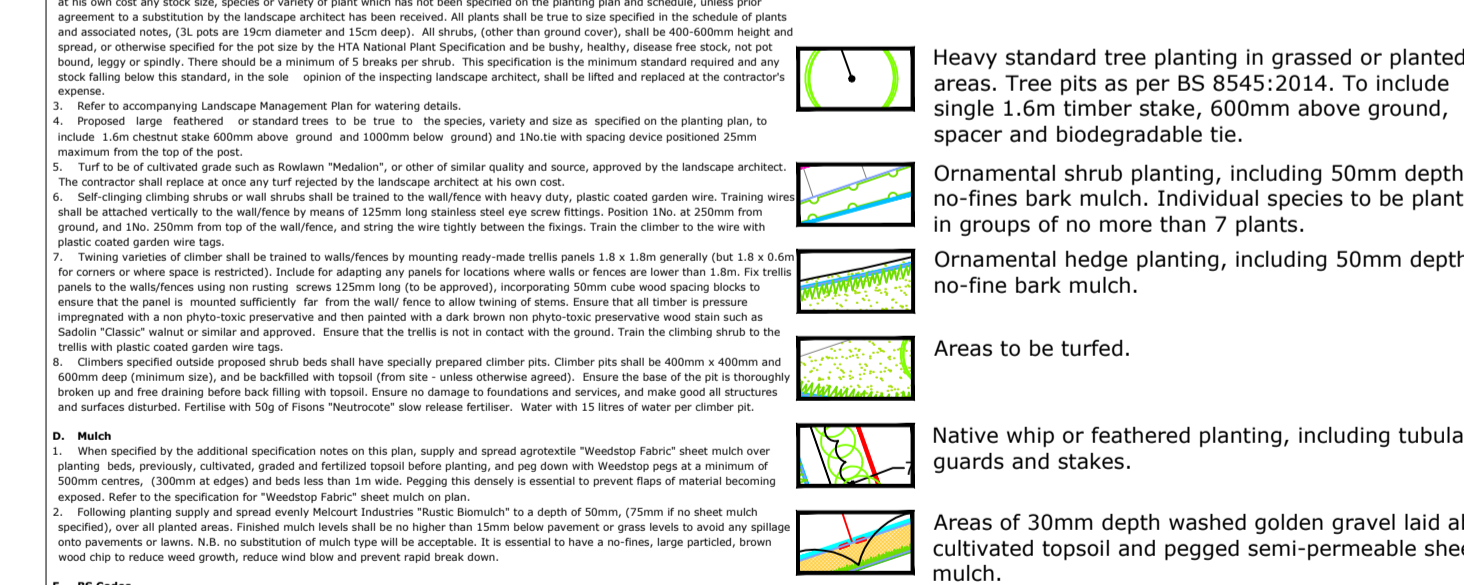

Client: **Barratt Homes Manchester**

Project: **Hattersley Phase 7 Site 28**

Drawing title: **Detailed landscape proposals**

Scale: **1:200 @ A1** | Drawn by: **PDP** | Date: **Oct 2019**

Drawing No.: **c-1730-01** | Revision: **C**

**PDP Associates**  
 Great Ards  
 2000  
 01763 54130  
 info@pdp.co.uk